

**FLOOR**  
**B**

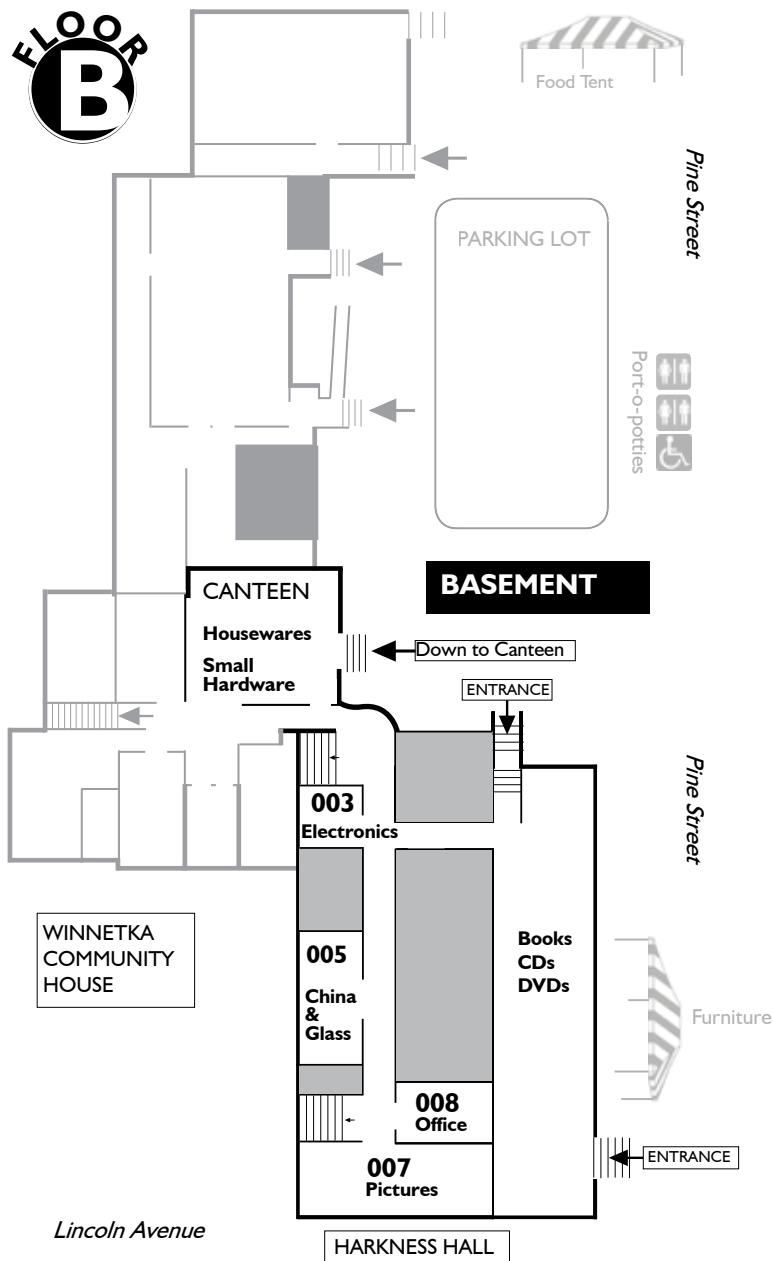

# WCC Spring Rummage Sale

May 2017



7 AM - 3 PM

Fall Sale:  
October 21  
8 AM-2 PM

## DEPARTMENTS ROOM FLOOR

Accessories.....	223	②
Bicycles.....	Parking Lot	①
Books/CD's/DVD's.....	Basement	ⓑ
Boys and Girls.....	Chapel	①
Check Room.....	Long Hall	①
China & Glass.....	005	ⓑ
Contemporary Boutique.....	204/205	②
Electronics.....	003	ⓑ
<b>FIRST AID.....</b>	<b>LOBBY</b>	<b>①</b>
French Room.....	206	②
Furniture.....	Matz Hall and tent	①
Garden.....	104	①
Gift Gallery.....	225	②
Hardware Large.....	Parking Lot	①
Hardware Small.....	Canteen	ⓑ
Housewares.....	Canteen	ⓑ
Infants & Toddlers.....	117	①
Jewelry.....	227	②
Lamps & Rugs.....	Matz Hall	①
Linens.....	103	①
Lingerie/Activewear/Outerwear.....	203	②
Men's.....	Attic	<b>Attic</b>
Pictures.....	007	ⓑ
Purses.....	222	②
Rummage Office.....	008	ⓑ
Sewing & Crafts.....	115	①
Shoes.....	Attic	<b>Attic</b>
Toys/Sporting Goods.....	Gym	①
Treasures.....	102	①
Variety Store.....	113	①
Vintage.....	112	①
Women's.....	101	①
Women's Outerwear.....	204	②

**FLOOR**  
**I**

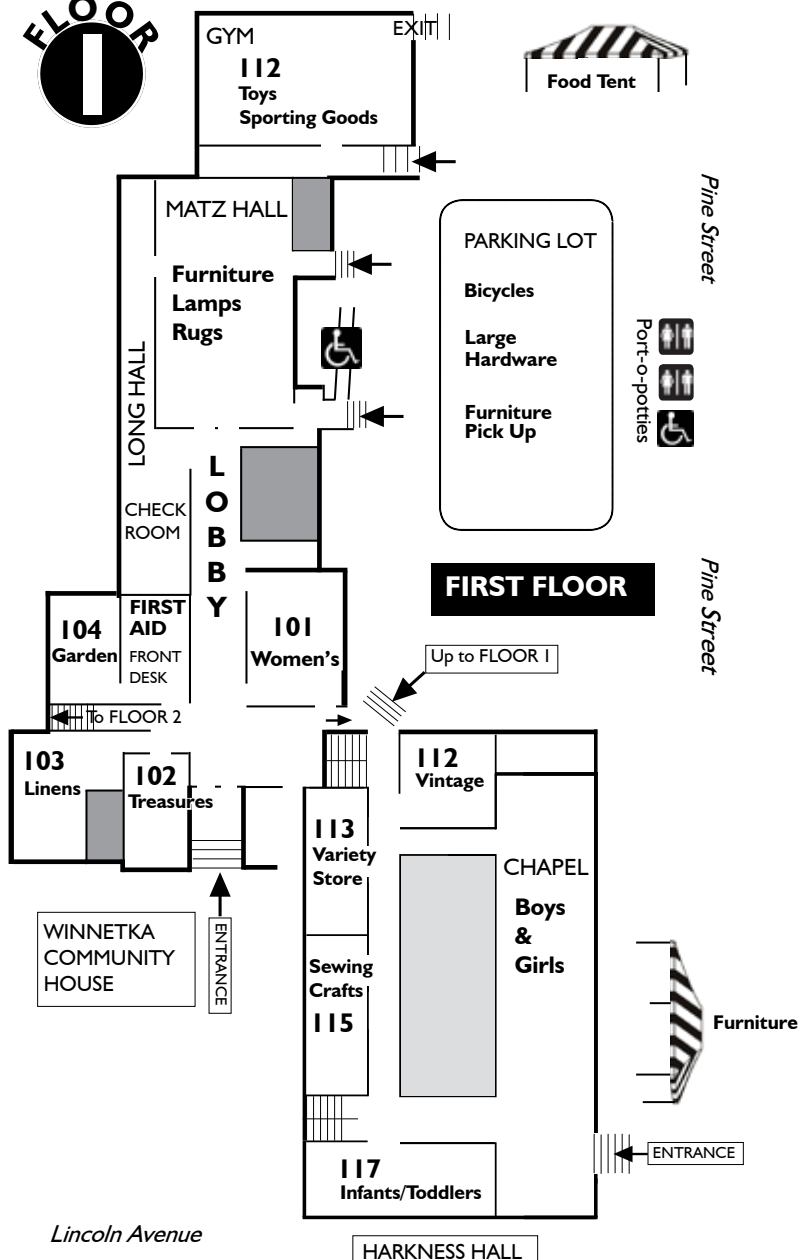

ALL SALES ARE FINAL.  
ALL PROCEEDS GO TO CHARITY.

# FLOOR 2

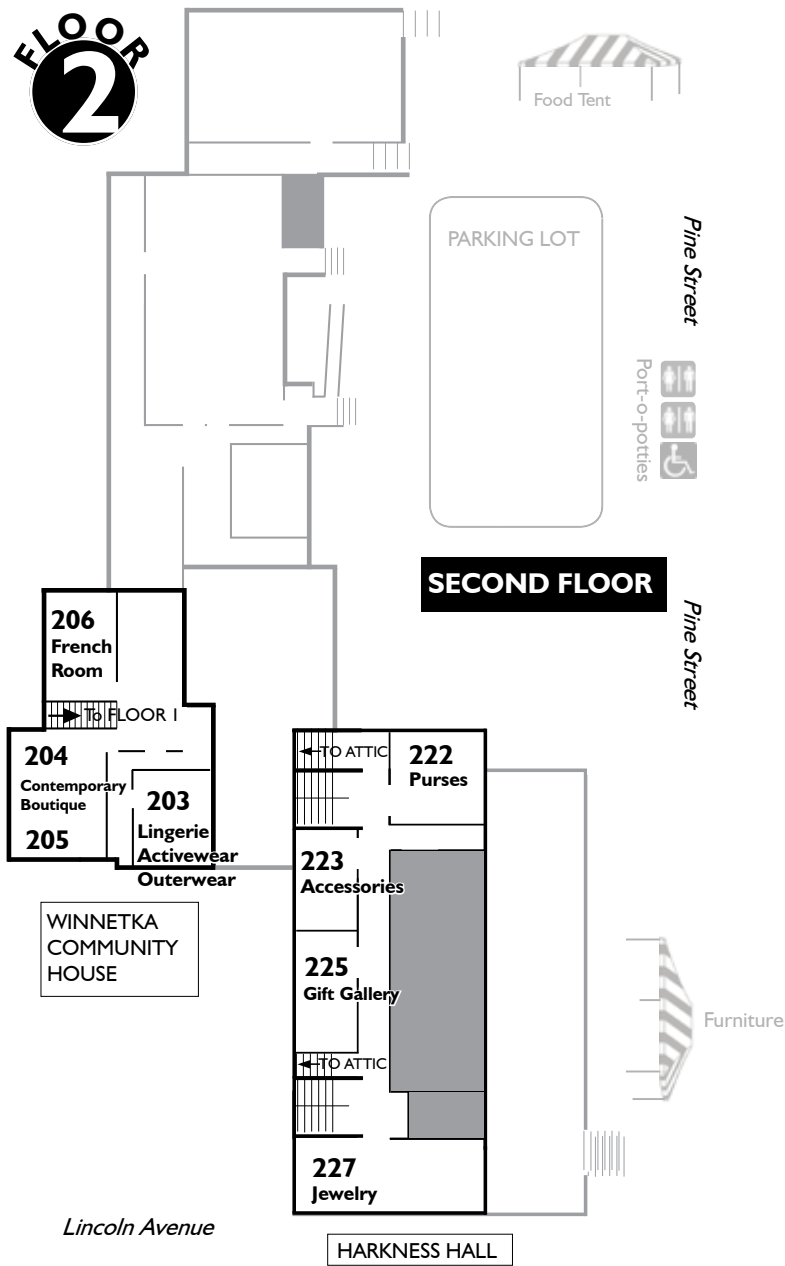

# FLOOR ATTIC

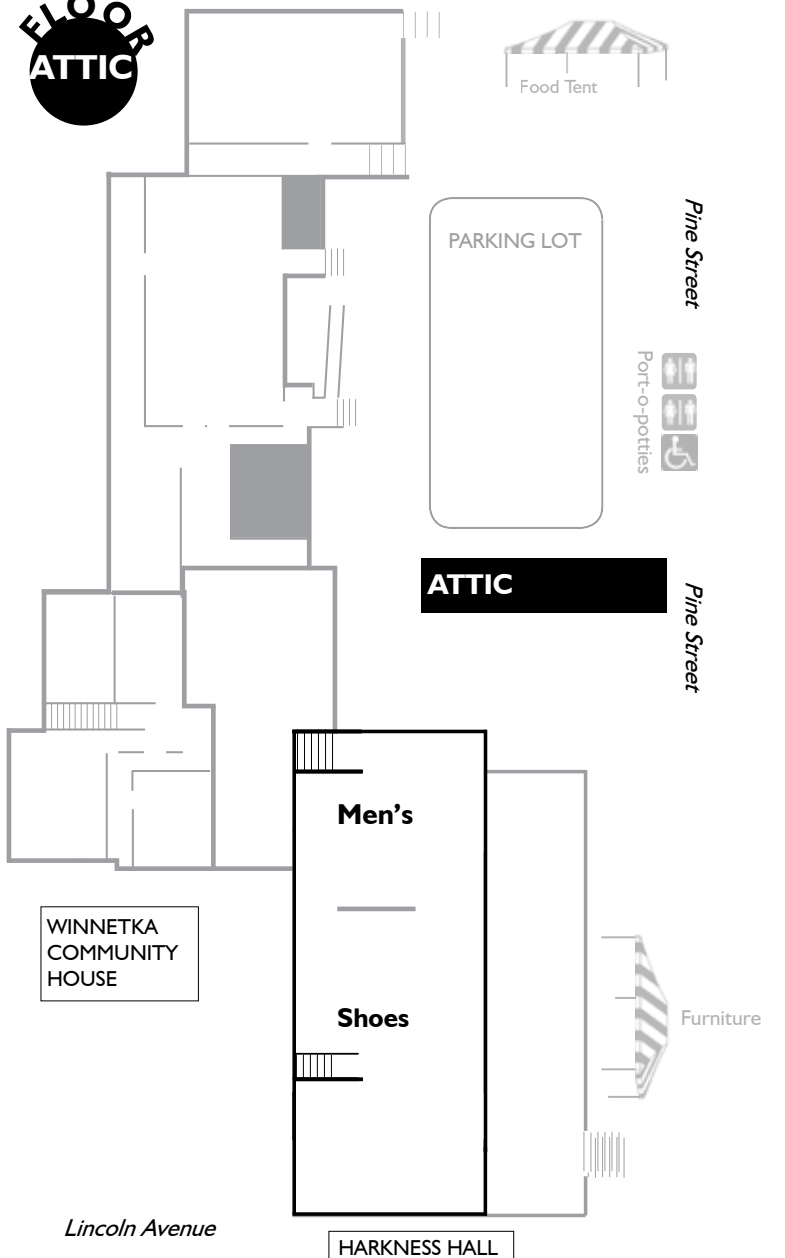

## DEPARTMENTS ROOM FLOOR

Accessories.....	223	②
Bicycles.....	Parking Lot	①
Books/CD's/DVD's.....	Basement	Ⓑ
Boys and Girls.....	Chapel	①
Check Room.....	Long Hall	①
China&Glass.....	.005	Ⓑ
ContemporaryBoutique.....	204/205	②
Electronics.....	.003	Ⓑ
<b>FIRST AID.....</b>	<b>LOBBY</b>	<b>①</b>
French Room.....	206	②
Furniture.....	Matz Hall and tent	①
Garden.....	104	①
Gift Gallery.....	225	②
Hardware Large.....	Parking Lot	①
Hardware Small.....	Canteen	Ⓑ
Housewares.....	Canteen	Ⓑ
Infants & Toddlers.....	117	①
Jewelry.....	227	②
Lamps & Rugs.....	Matz Hall	①
Linens.....	103	①
Lingerie/Activewear/Outerwear....	203	②
Men's.....	Attic	Attic
Pictures.....	.007	Ⓑ
Purses.....	222	②
RummageOffice.....	.008	Ⓑ
Sewing&Crafts.....	115	①
Shoes.....	Attic	Attic
Toys/Sporting Goods.....	Gym	①
Treasures.....	102	①
Variety Store.....	113	①
Vintage.....	112	①
Women's.....	101	①
Women's Outerwear.....	204	②

[www.wccrummage.com](http://www.wccrummage.com)

### Payment options:

- CASH
- CHECK - \$25 minimum
- CC - \$50 minimum

Additional ATM Locations:

**North Shore Community Bank**  
576 Lincoln Avenue | (847) 441-2265

**JPMorgan Chase Bank**  
791 Elm Street | (847) 501-6501